

13 12 11 10 9 8 7 6 5 4 3 2 1

| EDP NO. | ENG NO. |
|------------|----------------|
| 08-01-0101 | I797-AA(P909) |
| 08-01-0102 | I797-AA(P909)L |
| 08-06-0101 | I797-AA(550) |
| 08-06-0102 | I797-AA(550)L |
| 08-05-0103 | I797-AA(555) |
| 08-05-0104 | I797-AA(555)L |
| 08-03-0101 | I797-BA(P909) |
| 08-03-0102 | I797-BA(P909)L |
| 08-07-0101 | I797-BA(550) |
| 08-07-0102 | I797-BA(550)L |
| - - | I797-BA(555) |
| - - | I797-BA(555)L |

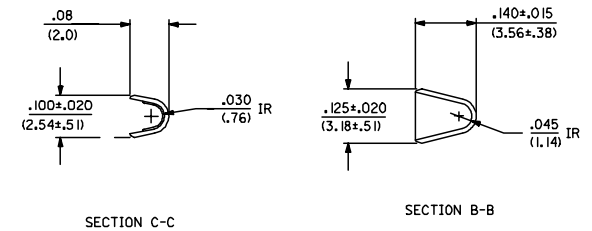
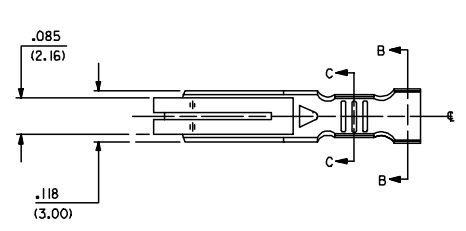

SECTION C-C SECTION B-B

18/24 AWG CRIMP

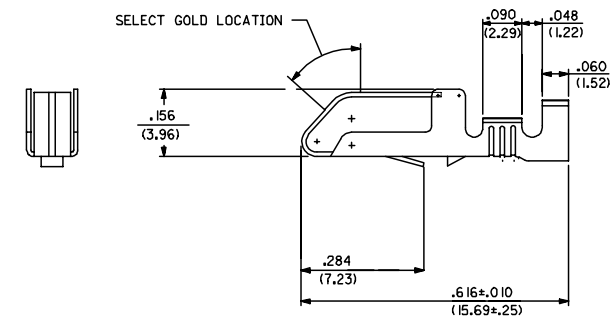

- NOTES:
1. MATERIAL: SEE LEGEND
 2. FINISH: (P909) - OVERALL HOT TIN DIP: .000100/(0.00254) MIN
(550) - SELECT GOLD: .000015/(0.00038) MIN.
OVERALL GOLD FLASH: .000002/(0.00005) MIN.
OVERALL NICKEL UNDERPLATE: .000030/(0.00076) MIN.
(555) - SELECT GOLD: .000015/(0.00038) MIN.
OVERALL NICKEL UNDERPLATE: .000030/(0.00076) MIN.
 - *THE PRIMARY SHIPPING CARTON WILL BE LABELED TO COMPLY WITH RoHS DIRECTIVE 2002/95/EC AND ELV ANNEX II OF DIRECTIVE 2000/53/EC. CARTONS WITHOUT THIS LABEL MAY CONTAIN PRODUCT WITH TIN-LEAD PLATING.
 3. PRODUCT SPECIFICATION: PS-08-50
 4. TERMINALS AVAILABLE IN CHAIN OR LOOSE FORM. SEE LEGEND.
 5. DIMENSIONS GIVEN ACROSS CENTERLINES ARE SYMMETRICAL ABOUT THOSE CENTERLINES WITHIN HALF THE TOTAL TOLERANCE.
 6. PART CONFORMS TO CLASS B REQUIREMENTS OF COSMETIC SPECIFICATION PS-45499-002.

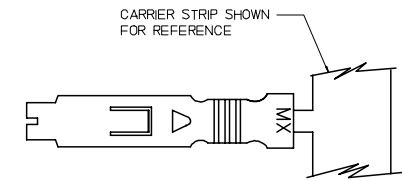

MATERIAL:
A= .011 THK BRASS
B= .011 THK PHOS BRONZE

WIRE SIZE
A=18 TO 24 AWG WIRE (SEE SHEET 1)
INS DIA. .060/.120
B=24 TO 30 AWG WIRE (SEE SHEET 2)
INS DIA. .040/.090
C=16 AWG WIRE (SEE SHEET 2)
INS DIA. .098 MAX

1797- ** (***)*
BLANK=CHAIN
L=LOOSE

PLATING
SEE NOTE 2

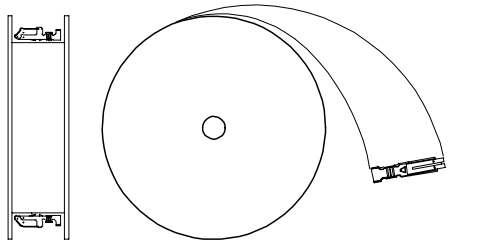

WINDING DIRECTION

| UPDATE NOTES FC NO: UCP2008-0273 DRAWN BY: DRW:ADERR 2007/10/03 CHK'D:LSHMI DT 2007/10/08 APPR:FSM TH 2007/10/09 Y1 | QUALITY SYMBOLS | GENERAL TOLERANCES (UNLESS SPECIFIED) | DIMENSION STYLE IN/MM | SCALE --- | DESIGN UNITS INCH | THIRD ANGLE PROJECTION | | | | | | | | | | | | | | | | | | | | | | | | | | | | | | | |
|---|----------------------------|--|---------------------------------|---|-----------------------------|-------------------------------|--------|---------|----------|--------|---------|----------|--------|-------|---------|-------|-------|---|----------|------|-------|--------|------------|---------------------------|------------|------|--|---------|------------|--|-------------|------|--|------|------------|--|-------------------------------|
| | | <table border="1"> <thead> <tr> <th></th> <th>mm</th> <th>INCH</th> </tr> </thead> <tbody> <tr> <td>4 PLACES</td> <td>± .010</td> <td>± .0004</td> </tr> <tr> <td>3 PLACES</td> <td>± .010</td> <td>± .0004</td> </tr> <tr> <td>2 PLACES</td> <td>± 0.25</td> <td>± .02</td> </tr> <tr> <td>1 PLACE</td> <td>± 0.5</td> <td>± .05</td> </tr> </tbody> </table> | | mm | INCH | 4 PLACES | ± .010 | ± .0004 | 3 PLACES | ± .010 | ± .0004 | 2 PLACES | ± 0.25 | ± .02 | 1 PLACE | ± 0.5 | ± .05 | <table border="1"> <thead> <tr> <th>DRAWN BY</th> <th>DATE</th> <th>TITLE</th> </tr> </thead> <tbody> <tr> <td>SAMIEC</td> <td>1992/08/13</td> <td>CRIMP TERMINAL BIFURCATED</td> </tr> <tr> <th>CHECKED BY</th> <th>DATE</th> <th></th> </tr> <tr> <td>ROBERTS</td> <td>1992/08/13</td> <td></td> </tr> <tr> <th>APPROVED BY</th> <th>DATE</th> <th></th> </tr> <tr> <td>LENZ</td> <td>1992/08/13</td> <td></td> </tr> </tbody> </table> | DRAWN BY | DATE | TITLE | SAMIEC | 1992/08/13 | CRIMP TERMINAL BIFURCATED | CHECKED BY | DATE | | ROBERTS | 1992/08/13 | | APPROVED BY | DATE | | LENZ | 1992/08/13 | | MOLEX INCORPORATED |
| | mm | INCH | | | | | | | | | | | | | | | | | | | | | | | | | | | | | | | | | | | |
| 4 PLACES | ± .010 | ± .0004 | | | | | | | | | | | | | | | | | | | | | | | | | | | | | | | | | | | |
| 3 PLACES | ± .010 | ± .0004 | | | | | | | | | | | | | | | | | | | | | | | | | | | | | | | | | | | |
| 2 PLACES | ± 0.25 | ± .02 | | | | | | | | | | | | | | | | | | | | | | | | | | | | | | | | | | | |
| 1 PLACE | ± 0.5 | ± .05 | | | | | | | | | | | | | | | | | | | | | | | | | | | | | | | | | | | |
| DRAWN BY | DATE | TITLE | | | | | | | | | | | | | | | | | | | | | | | | | | | | | | | | | | | |
| SAMIEC | 1992/08/13 | CRIMP TERMINAL BIFURCATED | | | | | | | | | | | | | | | | | | | | | | | | | | | | | | | | | | | |
| CHECKED BY | DATE | | | | | | | | | | | | | | | | | | | | | | | | | | | | | | | | | | | | |
| ROBERTS | 1992/08/13 | | | | | | | | | | | | | | | | | | | | | | | | | | | | | | | | | | | | |
| APPROVED BY | DATE | | | | | | | | | | | | | | | | | | | | | | | | | | | | | | | | | | | | |
| LENZ | 1992/08/13 | | | | | | | | | | | | | | | | | | | | | | | | | | | | | | | | | | | | |
| DRAFT WHERE APPLICABLE MUST REMAIN WITHIN DIMENSIONS | | SEE CHART | SD-1797 | THIS DRAWING CONTAINS INFORMATION THAT IS PROPRIETARY TO MOLEX INCORPORATED AND SHOULD NOT BE USED WITHOUT WRITTEN PERMISSION | | | | | | | | | | | | | | | | | | | | | | | | | | | | | | | | | |

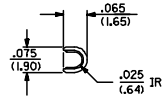
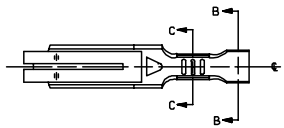

SECTION C-C

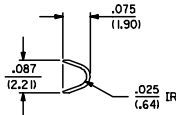

SECTION B-B

24-30 AWG CRIMP

| EDP NO. | ENG NO. |
|------------|----------------|
| 08-01-0105 | I797-AB(P909) |
| 08-01-0106 | I797-AB(P909)L |
| | |
| 08-06-0105 | I797-AB(550) |
| 08-06-0106 | I797-AB(550)L |
| 08-05-0105 | I797-AB(555) |
| 08-05-0106 | I797-AB(555)L |
| 08-03-0103 | I797-BB(P909) |
| 08-03-0104 | I797-BB(P909)L |
| | |
| - - | I797-BB(550) |
| - - | I797-BB(550)L |
| - - | I797-BB(555) |
| - - | I797-BB(555)L |

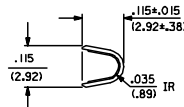
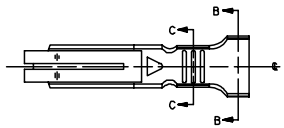

SECTION C-C

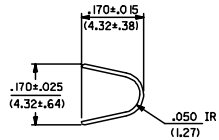

SECTION B-B

16 AWG CRIMP

| EDP NO. | ENG NO. |
|------------|----------------|
| 08-01-0116 | I797-AC(P909) |
| - - | I797-AC(P909)L |
| | |
| - - | I797-AC(550) |
| - - | I797-AC(550)L |
| - - | I797-AC(555) |
| - - | I797-AC(555)L |
| - - | I797-BC(P909) |
| - - | I797-BC(P909)L |
| | |
| - - | I797-BC(550) |
| - - | I797-BC(550)L |
| - - | I797-BC(555) |
| - - | I797-BC(555)L |

| | | | | | | | | |
|--|-------------------------------|---|--------------------|---|---------------------------------|--------------|-------------------|--|
| ADD 08-05-0106 DEC NO: UCP2008-0273 DRAWN BY: CHKCLSCHMIDT 2007/10/08 APPROVED BY: ESM TH 2007/10/09 AA1 | QUALITY SYMBOLS ▽=0 ▽=0 | GENERAL TOLERANCES (UNLESS SPECIFIED) | | DIMENSION STYLE IN/MM | | SCALE --- | DESIGN UNITS INCH | <input checked="" type="checkbox"/> THIRD ANGLE PROJECTION |
| | | 4 PLACES ± --- ± --- | DRAWN BY SAMIEC | DATE 1992/08/13 | TITLE CRIMP TERMINAL BIFURCATED | | | |
| | | 3 PLACES ± --- ± .010 | CHECKED BY ROBERTS | DATE 1992/08/13 | MOLEX INCORPORATED | | | |
| | | 2 PLACES ± 0.25 ± .02 1 PLACE ± 0.5 ± --- ANGULAR ±1/2° | APPROVED BY LENZ | DATE 1992/08/13 | MATERIAL NO. SD-1797 | DOCUMENT NO. | SHEET NO. 2 OF 2 | |
| DRAFT WHERE APPLICABLE MUST REMAIN WITHIN DIMENSIONS | | SEE CHART | | THIS DRAWING CONTAINS INFORMATION THAT IS PROPRIETARY TO MOLEX INCORPORATED AND SHOULD NOT BE USED WITHOUT WRITTEN PERMISSION | | | | |